

Metal Standard Split Ring Pipe Hanger Clamp

Basic Information

- Place of Origin: Jiangsu, China
- Brand Name: HENG TONG
- Model Number: PCH-008
- Minimum Order Quantity: 1000 pieces
- Price: \$0.50 - \$3.50/pieces
- Packaging Details: CARTON+PALLET
- Supply Ability: 1000000 Piece/Pieces per Month



Product Specification

- Material: Metal
- Standard Or Nonstandard: Standard
- Usage: Pipe Clamp
- Structure: Spring Clamp
- Port: Shanghai
- Highlight: Split Ring Pipe Hanger, Pipe Hanger Split Ring, Pipe Hanger

PCH型标准管夹
PCH-Type Pipe Ring, standard duty

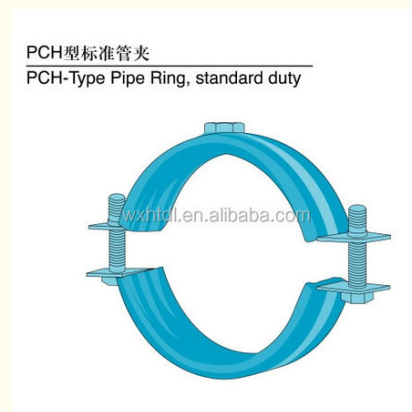

More Images



Product Description

Split Ring Pipe Hanger

They offer compatibility with various types of insulation materials, allowing for the installation of insulated pipe systems.

These clamps can be employed in the construction of scaffolding and temporary structures, providing support for pipes and conduits.

Pipe clamps provide stability and support for the installation of hydronic heating systems, such as radiant floor heating.

Pipe clamp is applied in the areas of pipeline systems. E.g.: sanitary and heating installations, gas distribution systems, air conditioning systems, etc..

— PCH型标准管夹 PCH-Type Pipe Ring, Standard duty

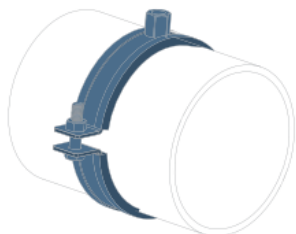

技术参数:

卡箍材质: 低碳钢
表面处理: 电镀锌
衬套材质: 惰性橡胶

Specification:

Clamp Material: Low Carbon Steel
Finish: Electro Galvanizing
Inlay Material: EPDM Rubber

重型管夹可以定制
Heavy duty series are available

管束编号 Part No.	管径范围 (mm) Size Range	吊杆 Rod	材料尺寸 (mm) Size of Steel	螺栓 Bolt	设计荷载 (KN) Design Load
PCH-006	8-11	M8/M10	1.5*20	M6	1.0
PCH-008	12-16	M8/M10	1.5*20	M6	1.0
PCH-010	17-20	M8/M10	1.5*20	M6	1.0
PCH-015	21-24	M8/M10	1.5*20	M6	1.0
PCH-020	25-28	M8/M10	1.5*20	M6	1.0
PCH-025A	29-32	M8/M10	1.5*20	M6	1.0
PCH-025	33-37	M8/M10	1.5*20	M6	1.0
PCH-032A	38-41	M8/M10	1.5*20	M6	1.0
PCH-032	42-46	M8/M10	1.5*20	M6	1.0
PCH-040	47-51	M8/M10	1.5*20	M6	1.0
PCH-050A	52-56	M8/M10	1.5*20	M6	1.0
PCH-050	57-61	M8/M10	1.5*20	M6	1.0
PCH-065B	62-66	M8/M10	2.0*25	M6	1.2
PCH-065A	67-71	M8/M10	2.0*25	M6	1.2
PCH-065	72-77	M8/M10	2.0*25	M6	1.2
PCH-080A	78-84	M8/M10	2.0*25	M6	1.2
PCH-080	87-93	M8/M10	2.0*25	M6	1.2
PCH-090	99-104	M10/M12	2.5*25	M8	2.5
PCH-100A	108-112	M10/M12	2.5*25	M8	2.5
PCH-100	114-118	M10/M12	2.5*25	M8	2.5
PCH-125B	123-128	M10/M12	2.5*25	M8	2.5
PCH-125A	131-137	M10/M12	2.5*25	M8	2.5
PCH-125	138-144	M10/M12	2.5*25	M8	2.5
PCH-150A	157-163	M10/M12	2.5*25	M8	2.5
PCH-150	164-170	M10/M12	2.5*25	M8	2.5
PCH-200	216-220	M10/M12	2.5*25	M8	2.5

Feature :

- 1) Bigger adjusting range
- 2) Evenly stress when fastening
- 3) Wrest resistant and high crushing strength
- 6) sizes: by customers' requirements
- 7) high quality and competitive price
- 8) It has different bandwidths as per the different sizes.
- 9) The band thickness is also different for different bandwidths







 **Wuxi Hengtong Metal Framing System Co., Ltd.**

 +86 15251535252  elinglu@htstrut.com  channel-fittings.com

No 6 East Dingxiang Road Hudai Industry Zone Wuxi City 214161 China